

When printed correctly, at A3, this line will measure 75mm at full size

• CHECK PRINTED SIZE

When printed correctly, at A3, this line will measure 75mm at full size

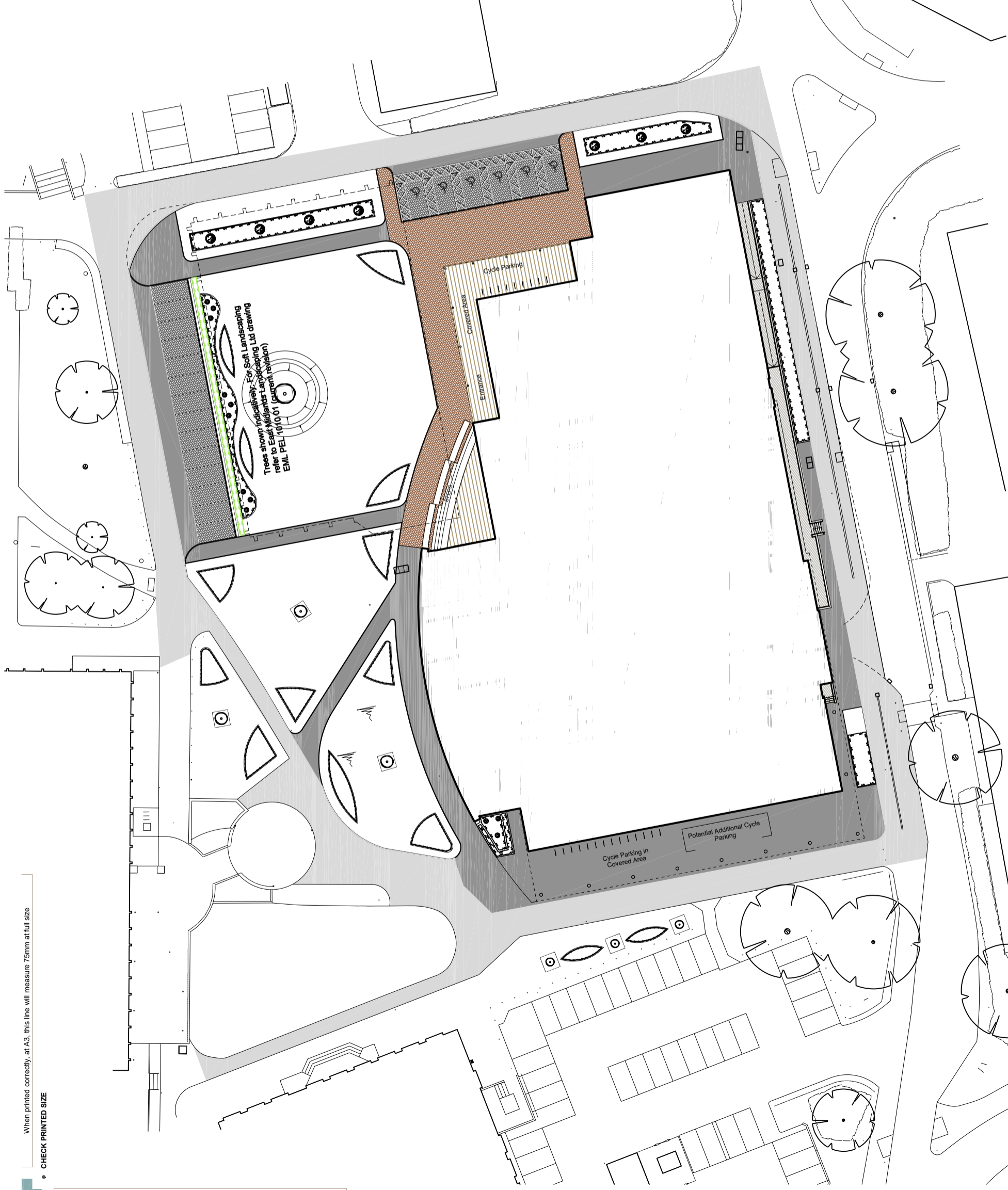

**LEGEND:**



PERMEABLE BLOCK PAVING TO PARKING AREAS  
COLOUR - HYDROPAVE PEDESTA, CHARCOAL  
(NATURAL PAVING TO FORM LINE MARKINGS)

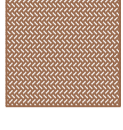

BLOCK PAVING TO FOOTPATHS  
COLOUR - TOBERMORE TEGULA, CEDAR



BLOCK PAVING TO FOOTPATHS & TERRACE  
COLOUR - TOBERMORE TEXTURED FLAGS, NATURAL  
INCLUDING MAYFAIR STEP FLAGS WITH CONTRASTING  
INSERTS.



TARMAC TO FOOTPATHS & PARKING  
COLOUR - NA



BRUSHED CONCRETE RAMP  
COLOUR - GREY



EXISTING TARMAC FOOTPATHS & ACCESS ROADS  
ILLUSTRATIVE. COLOUR - NA  
REFER TO HIGHWAYS AND CIVIL ENGINEER'S DRAWINGS

**IMAGES:**



PERMEABLE BLOCK PAVING TO PARKING AREAS  
COLOUR - HYDROPAVE PEDESTA, CHARCOAL  
(NATURAL PAVING TO FORM LINE MARKINGS)



BLOCK PAVING TO FOOTPATHS  
COLOUR - TOBERMORE TEGULA, CEDAR



BLOCK PAVING TO FOOTPATHS & TERRACE  
COLOUR - TOBERMORE TEXTURED FLAGS,  
NATURAL

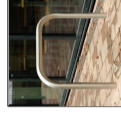

CYCLE HOOPS  
STAINLESS STEEL

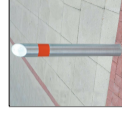

BOLLARDS  
STAINLESS STEEL 114Ø REF: BC47-003 RT  
Note: Bollards to Disabled Bays to have reflective banding